

CORE SETS

Effective core parameters

SYMBOL	PARAMETER	VALUE	UNIT
$\Sigma (1/A)$	core factor ( $C_1$ )	1.11	$\text{mm}^{-1}$
$V_e$	effective volume	2988.86	$\text{mm}^3$
$l_e$	effective length	57.70	mm
$A_e$	effective area	51.80	$\text{mm}^2$
$A_{\text{min}}$	minimum area	51.34	$\text{mm}^2$
$W_t$	mass of core set	$\approx 15.1$	g

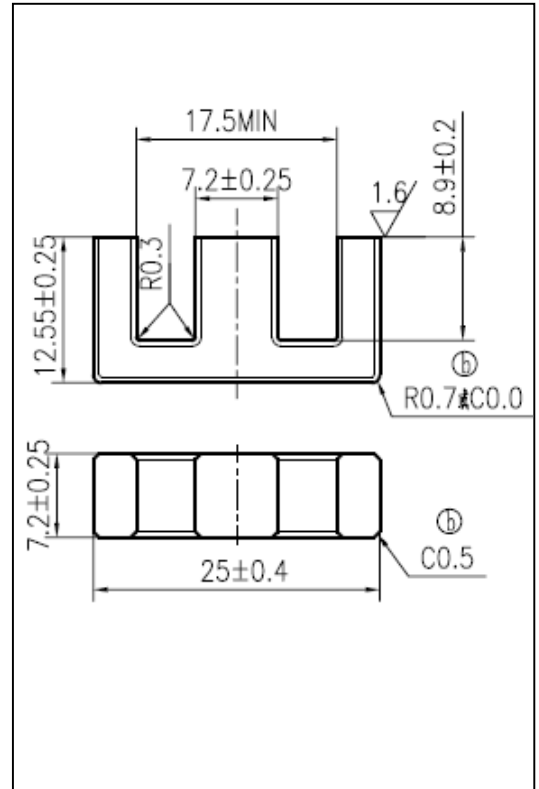

Characteristic

GRADE	AL ( $\text{nH}/\text{N}^2$ )	B (mT)	CORE LOSS (W)
	f=10kHz U=0.25V	H=250A/m f=25kHz T=100°C	f=100kHz B=200mT T=100°C
DMR40	$1900 \pm 25\%$	$\geq 320$	$\leq 1.89$
DMR40D	$1700 \pm 25\%$	$\geq 320$	$\leq 2.12$
DMR44	$1900 \pm 25\%$	$\geq 320$	$\leq 1.65$
DMR47	$2100 \pm 25\%$	$\geq 340$	$\leq 1.50$
DMR95	$2600 \pm 25\%$	$\geq 340$	$\leq 1.65$

GRADE	AL ( $\text{nH}/\text{N}^2$ )	$\mu_i$
	f=10kHz U=0.25V	f=10kHz U=0.25V
R4K	$3850 \pm 25\%$	$\approx 4300$
R5K	$4200 \pm 25\%$	$\approx 5000$
R7K	$5600 \pm 25\%$	$\approx 7000$
R10K	$7200 \pm 30\%$	$\approx 10000$
R12K	$\geq 6050$	$\approx 12000$