

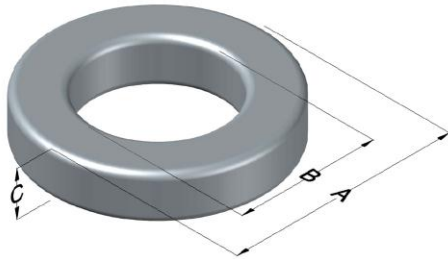

C058322A2

110 Delta Drive
 Pittsburgh, PA 15238
 NAFTA Sales: (1)800-245-3984
 HK Sales : (852)3102-9337
 magnetics@spang.com
 www.mag-inc.com



High Flux Permeability (μ)	A_L (nH/T ²)	Core Marking			Coating Color
		Lot Number	Part Number	Inductance Grade	
160	150 \pm 8%	XXXXXX	58322A2	X	Khaki

Dimensions	Uncoated		Coated Limits		Packaging
	(mm)	(in)	(mm)	(in)	
OD (A)	35.80	1.410	36.71	1.445	Cardboard cut-outs Box Qty= 220 pcs
ID (B)	22.4	0.880	21.5	0.848	
HT (C)	10.5	0.412	11.4	0.447	

Electrical Characteristics			Physical Characteristics						
Watt Loss @ 100 kHz, 100mT typical (mW/cm ³)	DC Bias typical (A-T/cm)		Voltage Breakdown wire to wire min (V _{AC})	Break Strength min (kg)	Window Area W _A (mm ²)	Cross Section A _e (mm ²)	Path Length L _e (mm)	Volume V _e (mm ³)	Weight (g)
	80%	50%							
1500	25.8	50.1	1000	50	364	67.8	89.8	6,090	50

Winding Information				Temperature Rating	
Winding Length Per Turn				Wound Coil Dimensions (mm)	
Winding Factor	(mm)	Winding Factor	(mm)	Maximum OD (70%)	
				Maximum HT (70%)	
0%	37.9	40%	48.9	Surface Area (mm ²)	
20%	43.5	45%	50.6	Unwound Core	
25%	44.8	50%	52.0	40% Winding Factor	
30%	46.0	60%	55.5	3,450	
35%	47.6	70%	59.3	5,510	
				Curie Temp: 500°C	
				Coating Temp (Continuous up to): 200°C	
				Notes:	

Typical DC Bias Performance

